



The University of Wisconsin – Milwaukee Master Plan

Board of Regents Presentation - June 10, 2010

**Christy Brown - Vice Chancellor
Finance & Administrative Affairs**

**Bob Greenstreet – Dean School of
Architecture, Chair of Master Plan
Coordinating Committee**



Integrated Planning

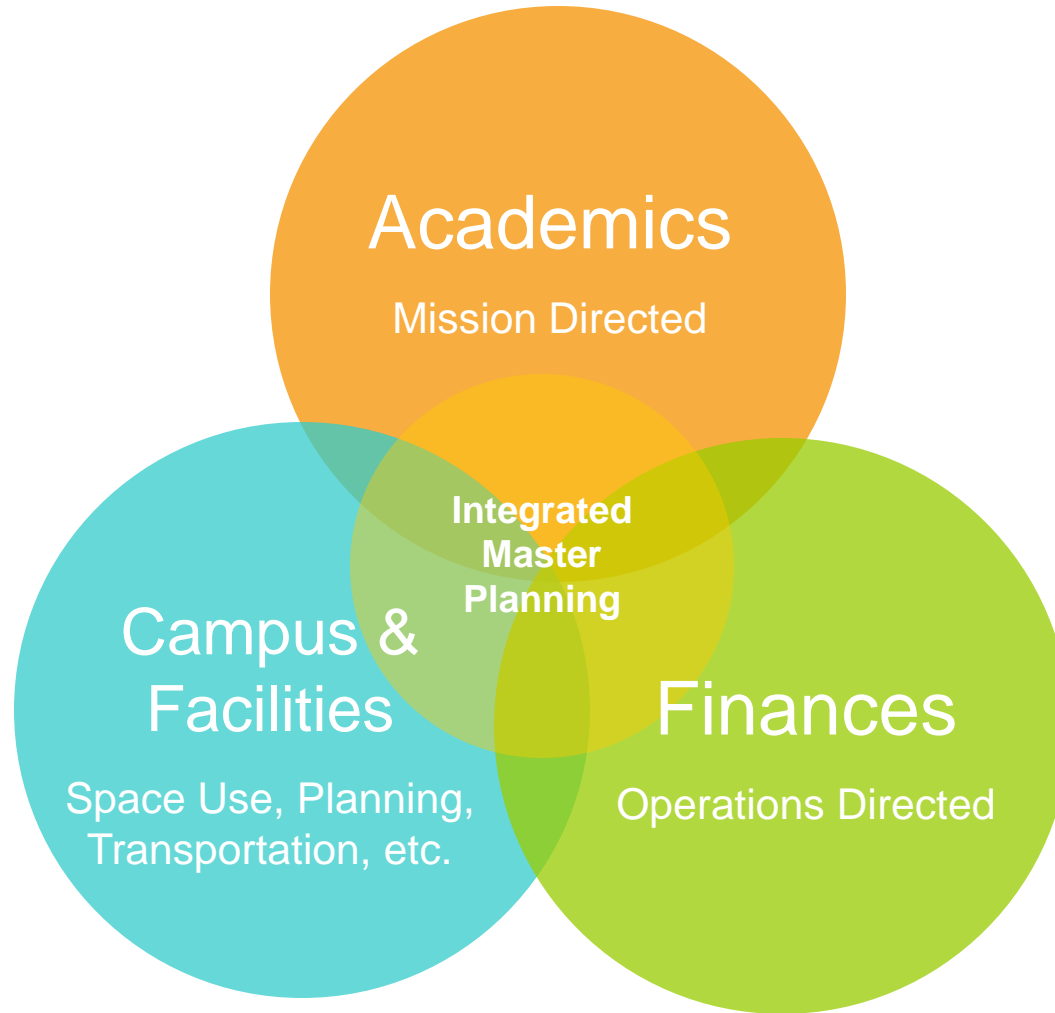

Schedule

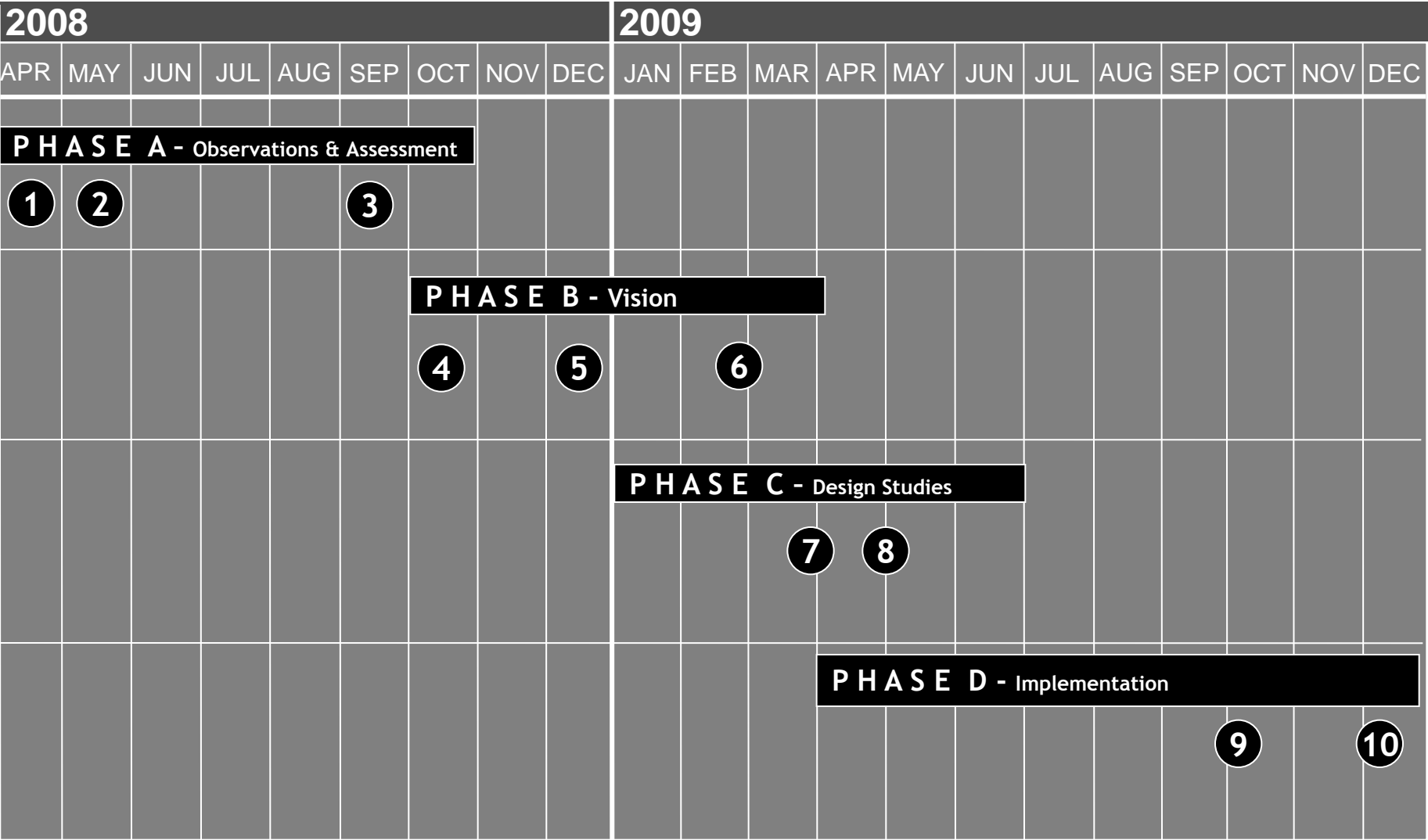

1 Work Sessions

Process

- 100+ meetings, presentations, and listening sessions to campus, community, and partners
- 100+ campus representatives on master plan committees
- Over 300 electronic feedback & survey responses
- More than 500 participants in master planning presentations and listening sessions



Master Plan Toolkit

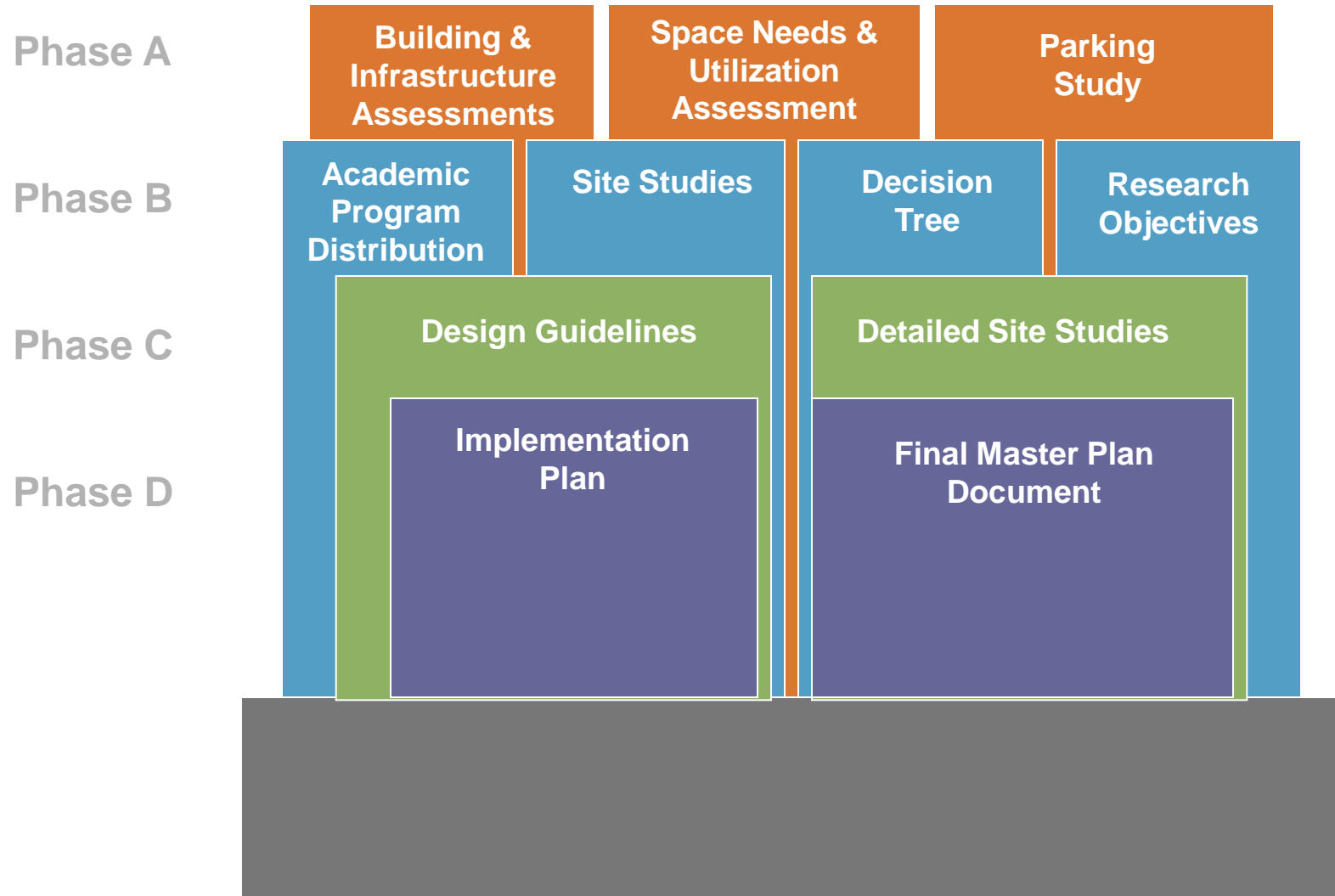

Master Plan Guiding Principles



- Open
 - Responsive
 - Rigorous
 - Bold
-
- Learning & Discovery
 - Access & Campus Life
 - Research Growth & Partnerships
 - Location & Connectivity
 - Stewardship

Space Needs Assessment

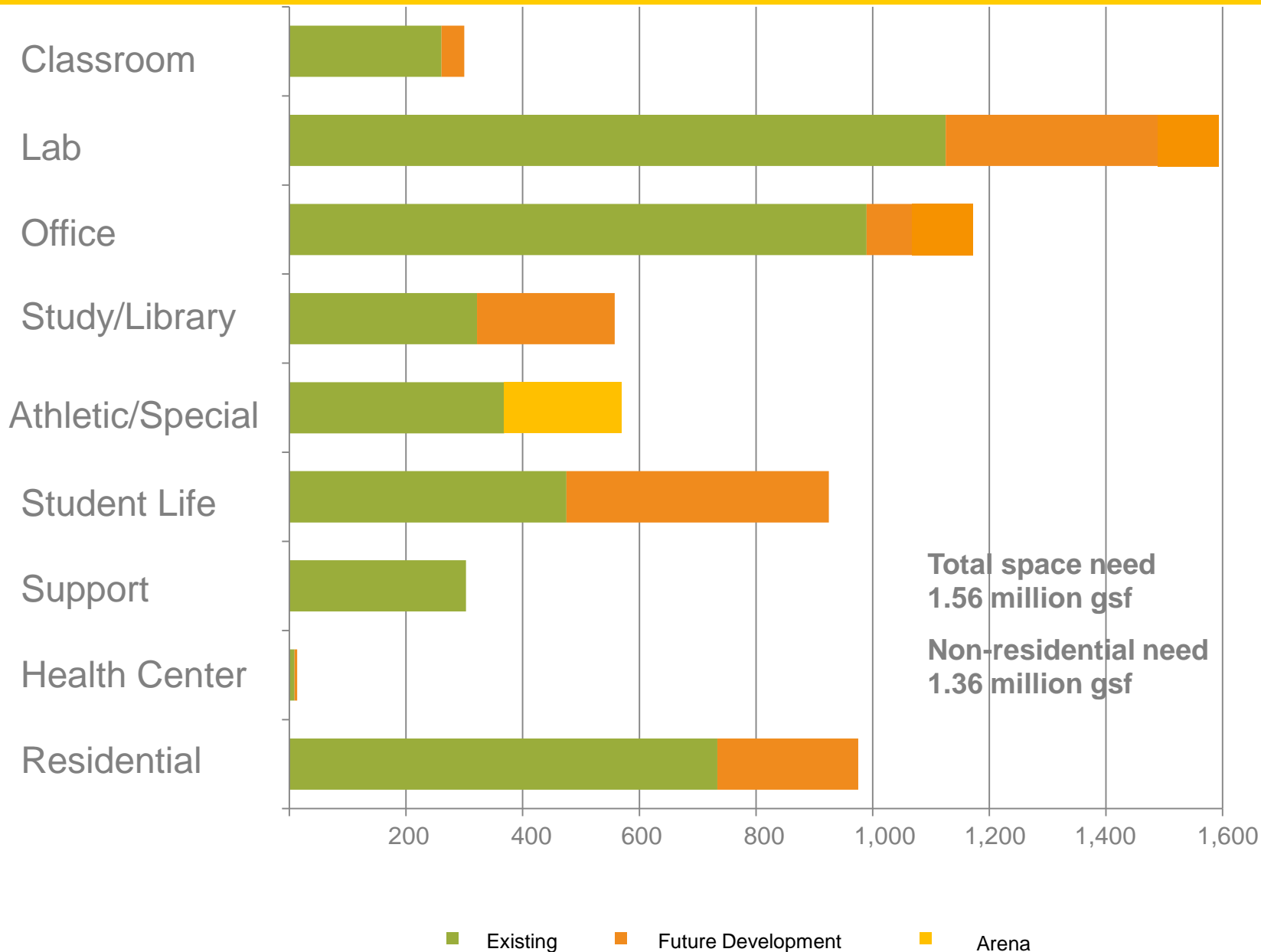



UWM Master Plan Content

- Planning Context
- Guiding Principles
- Academic & Campus Life Program
- Kenwood Campus & the East Side
- Kenwood Design Guidelines
- Opportunity Sites
- Transportation
- Sustainability
- Implementation

Appendices

- Space
- Transportation & Parking
- Campus Energy, Utilities & Infrastructure
- Implementation

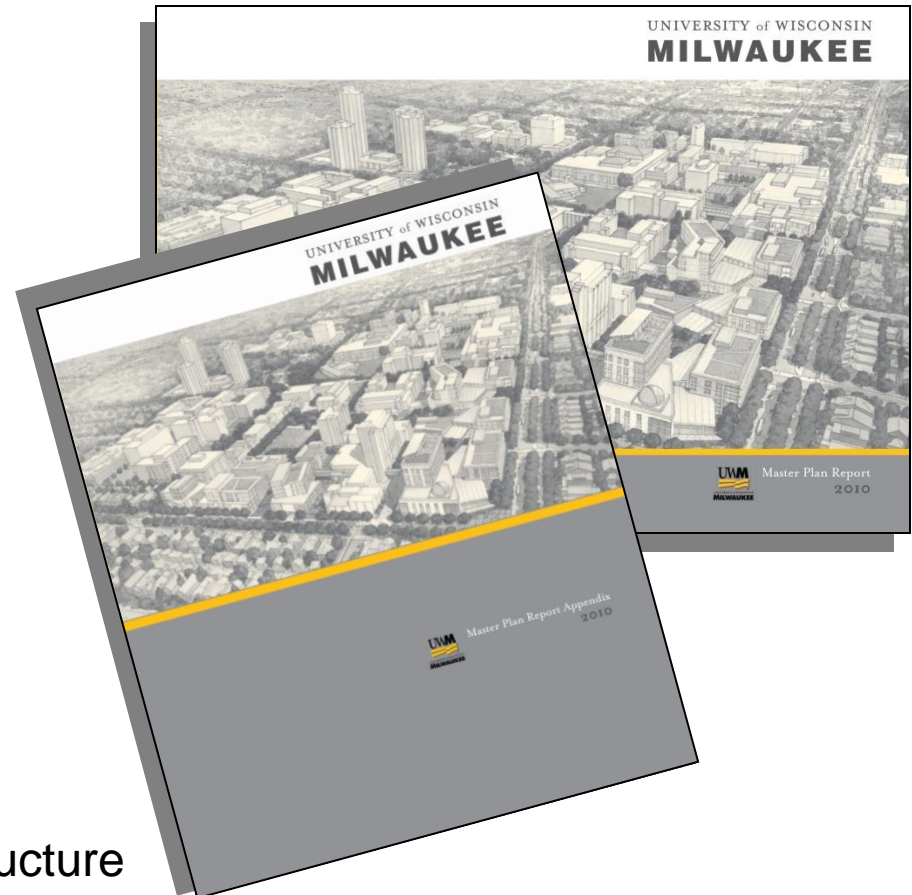

UWM Master Plan

- Kenwood as the heart of the academic experience
- Strategic Access mission is achieved by locating facilities at a series of opportunity sites

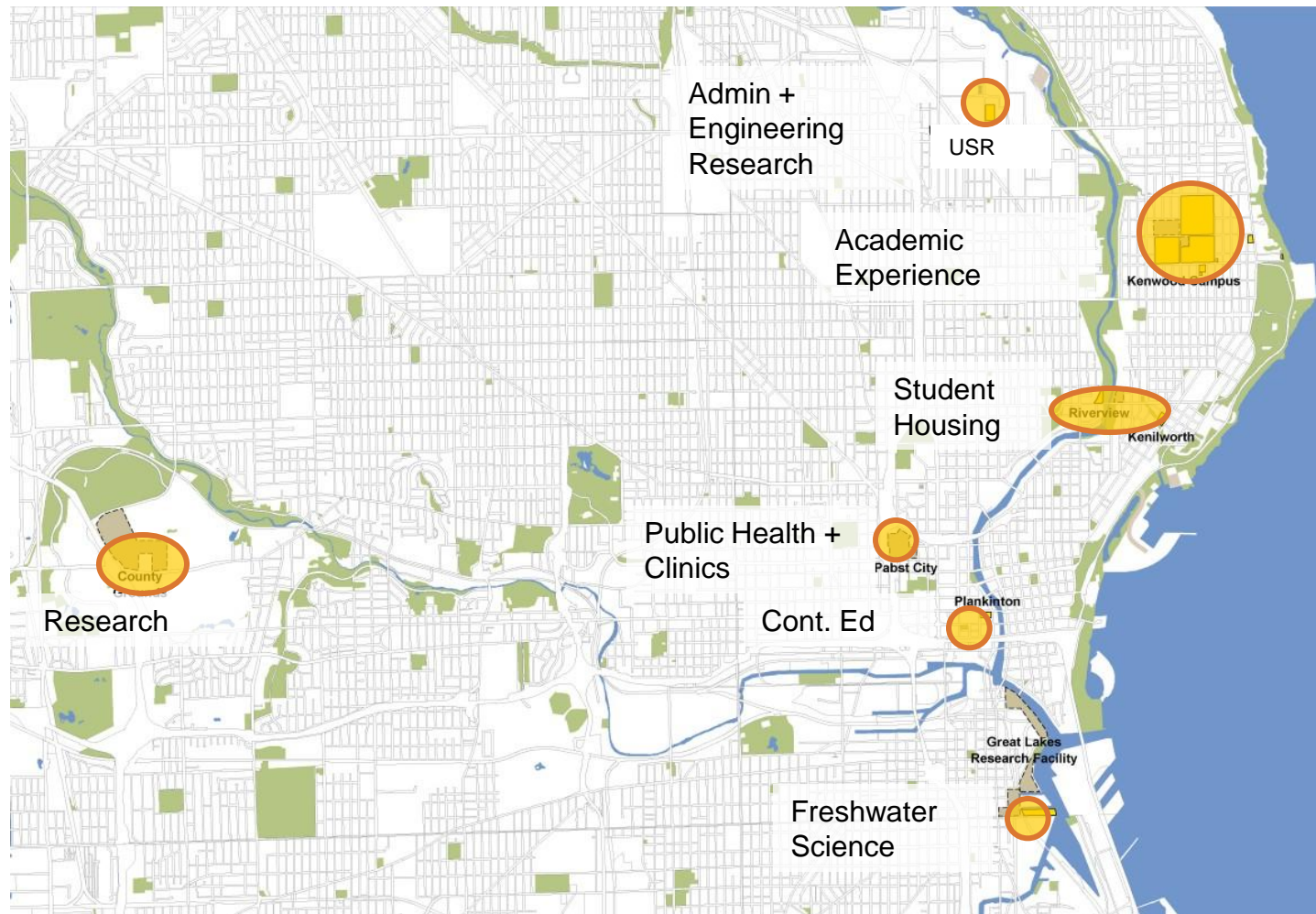

Kenwood Re-imagined



A new face to Kenwood Boulevard



Extending Downer Woods south



Englemann Quad Re-imagined

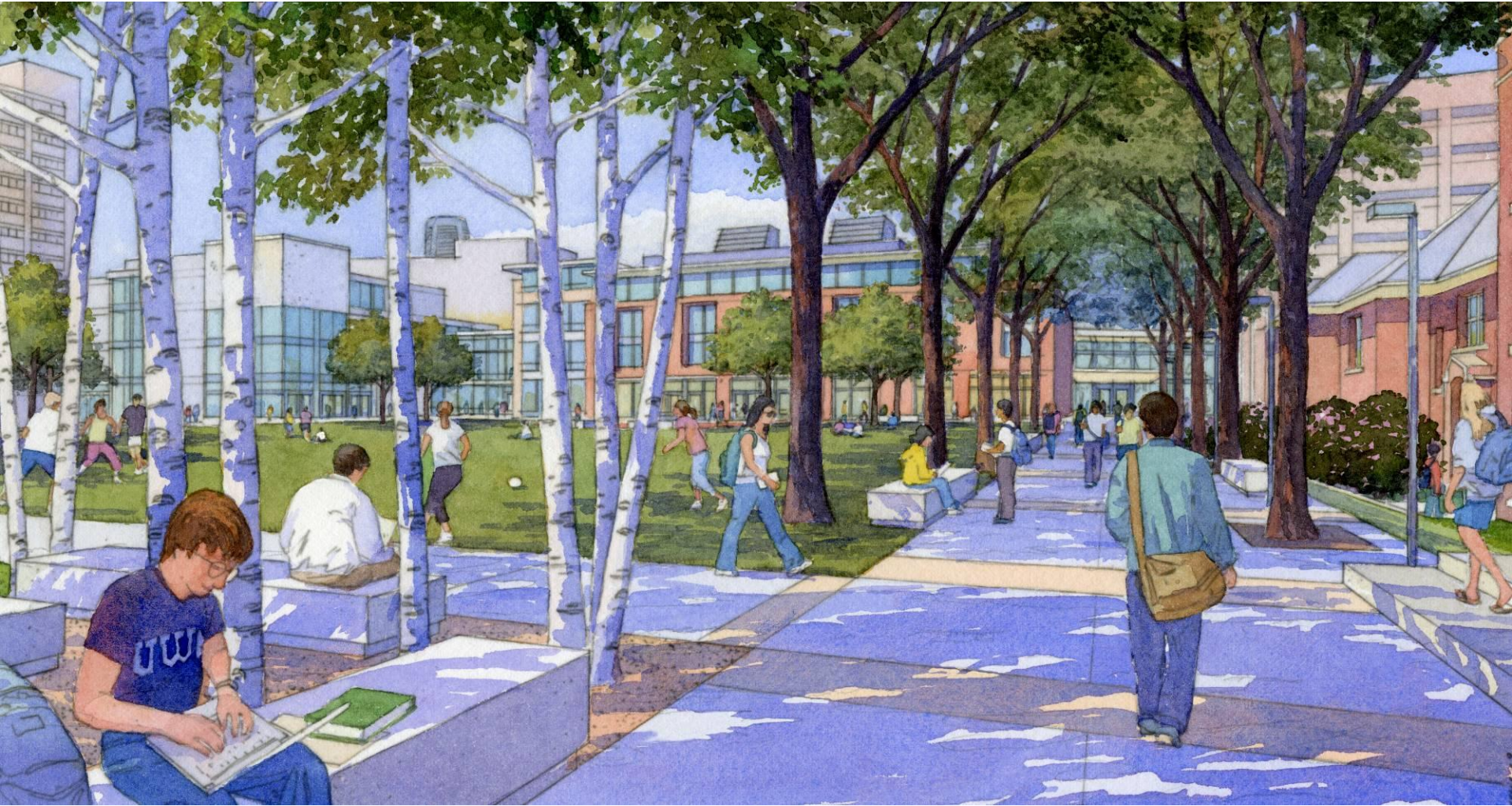

Interconnected Learning Environments: Library

- Interior spine of social and learning spaces
- Outdoor campus connections

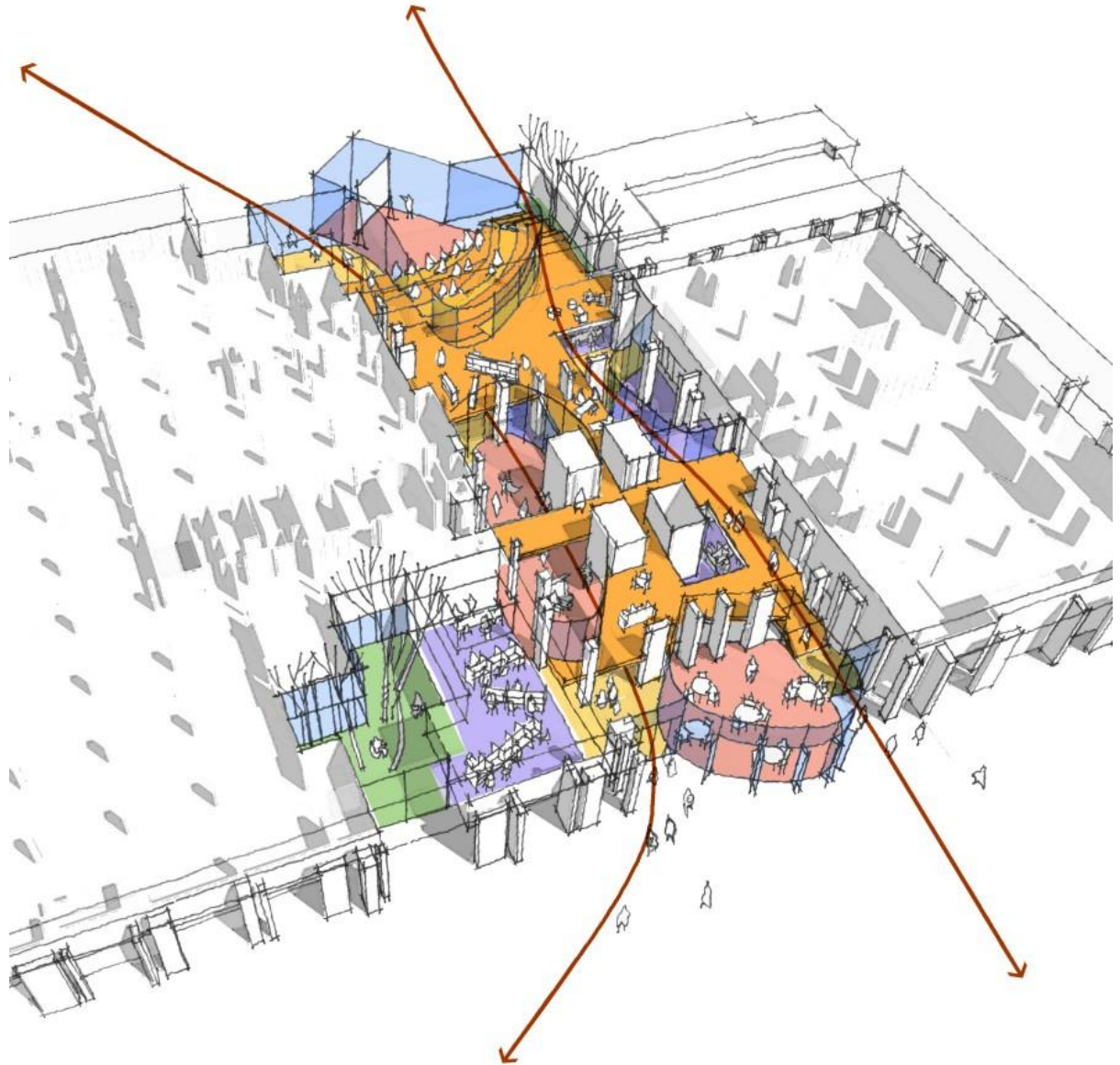

View toward the Library



Arriving from the west



Interconnected Learning Environments: IRC

- Interior spine of social and learning spaces
- Outdoor campus connections

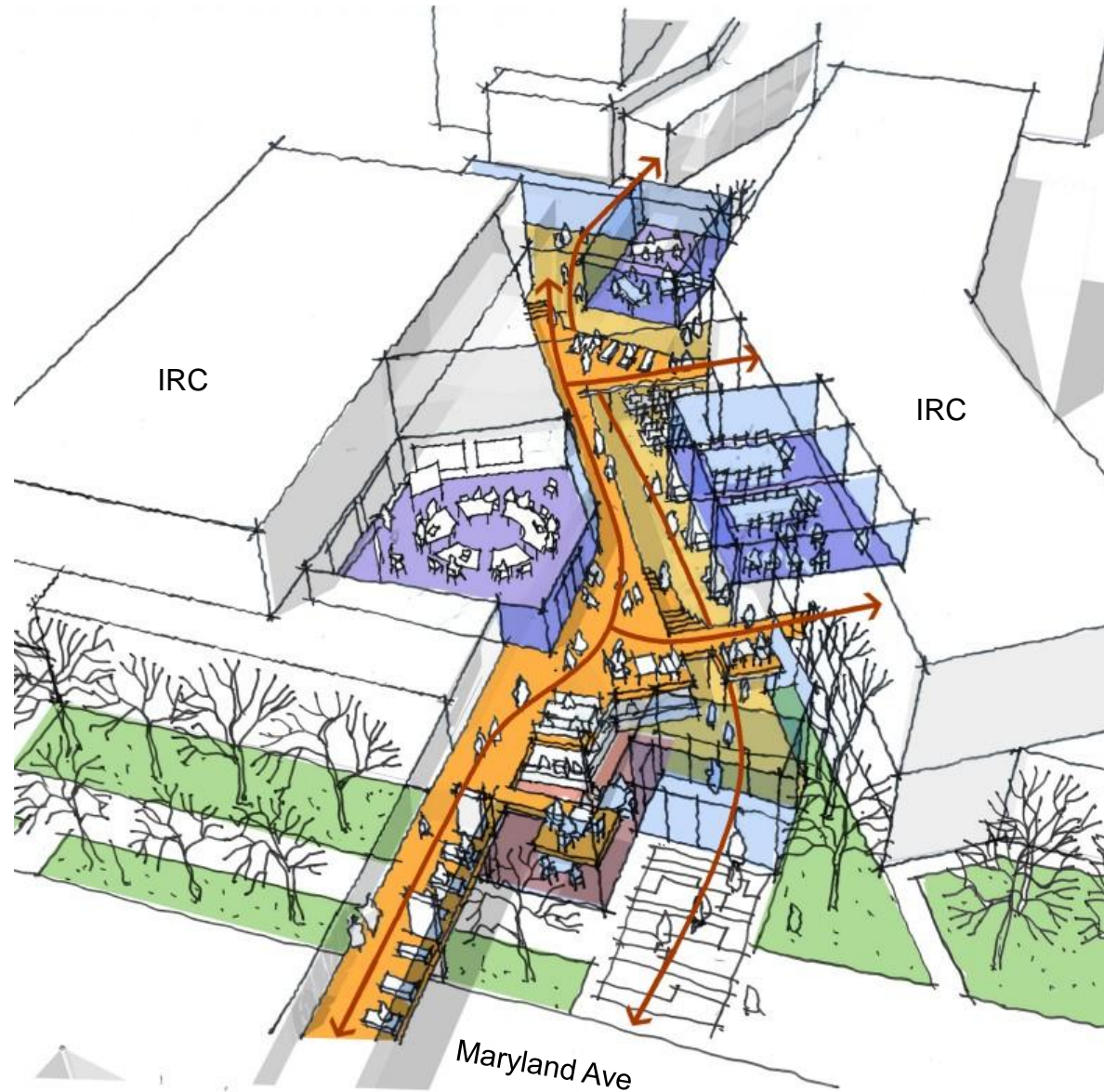

Opportunity Sites – The Harbor

- Growth for Freshwater Science at existing GLRF location
- Opportunities for expansion and partnership on adjacent sites

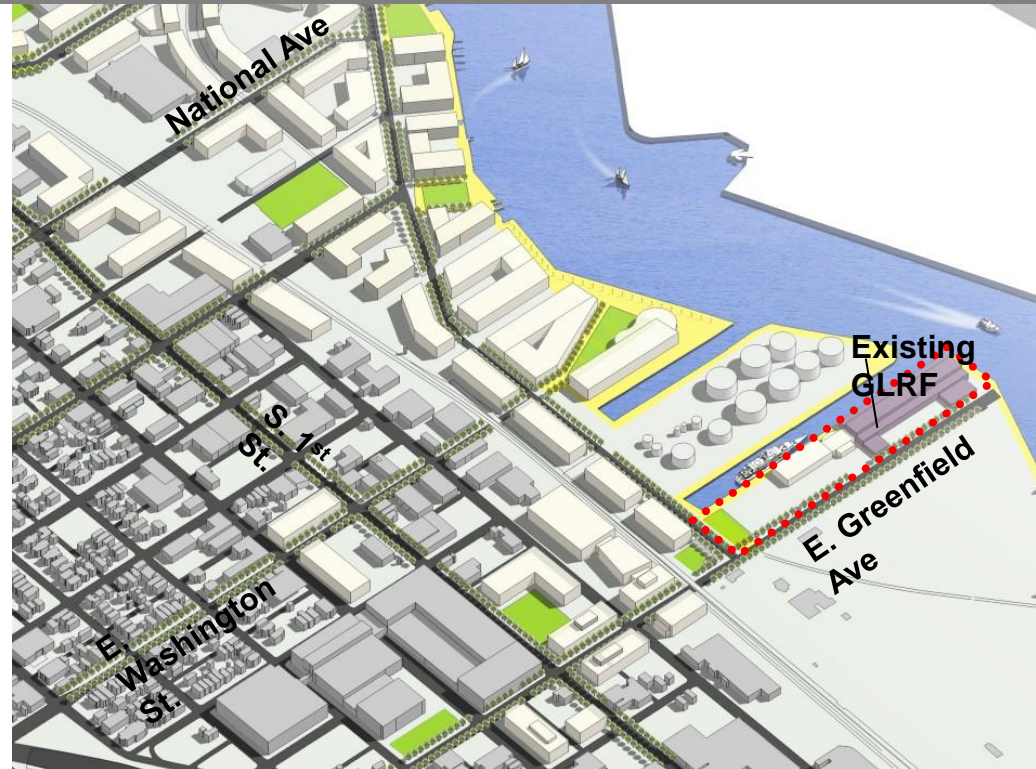

Opportunity Sites – The Brewery

- Public, Community & Clinical Health
- Highly integrated into urban fabric

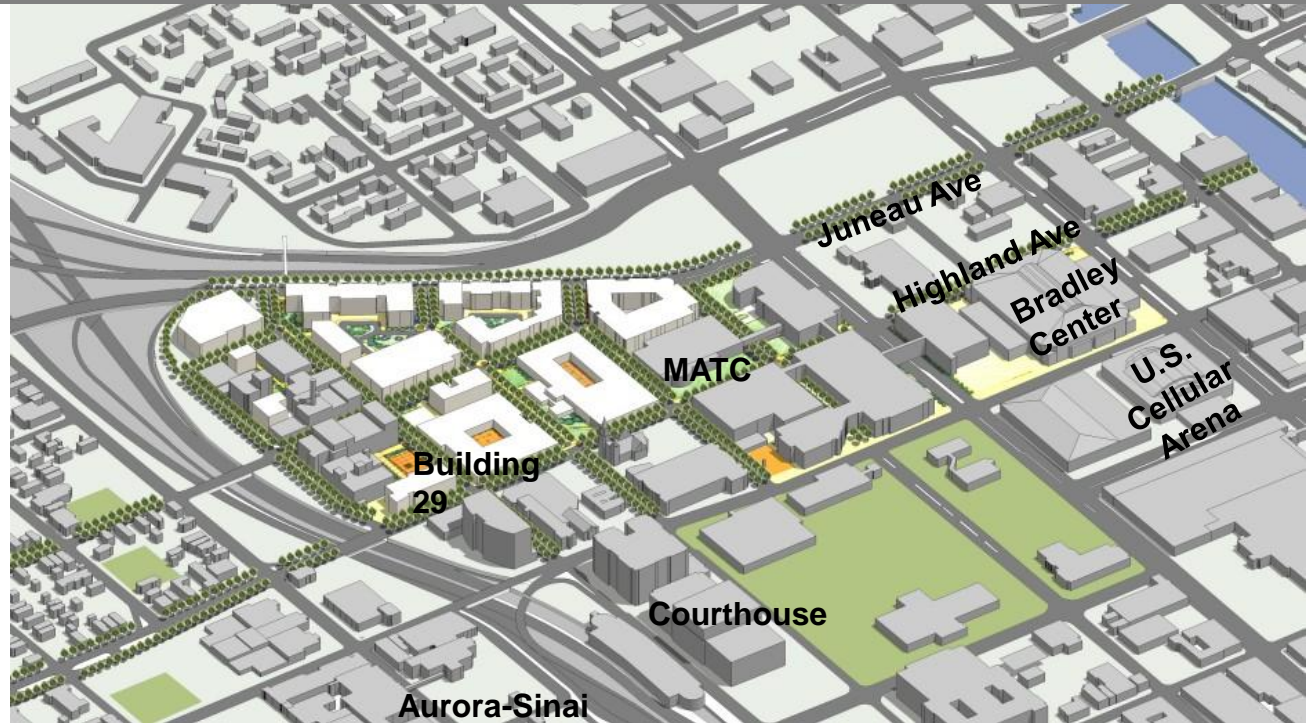

Opportunity Sites – Innovation Park

- Hub for research and partnerships, particularly in areas of biomedical engineering
- Emphasize sustainable development principles
- Preserves key habitat areas and respects historic structures



Opportunity Sites – Columbia – St. Mary's

- Development opportunity adjacent to Kenwood Campus
- Could support academic, student services, recreation, and other needs
- Existing parking amenity on site



Transportation

Goals:

- Provide an integrated & comprehensive transportation system that includes pedestrian, transit, bicycle, vehicular, and parking networks
- Create an efficient, accessible and financially feasible transportation system
- Reduce the vehicle miles traveled by providing safe and reliable transportation options.

Existing student mode split

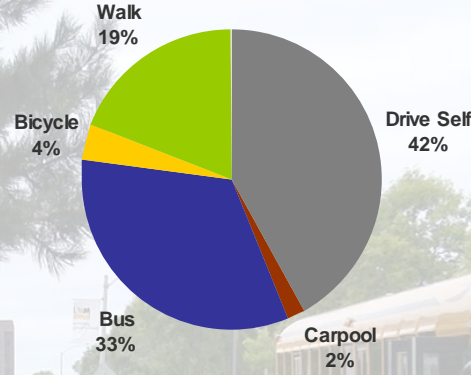

Existing faculty/ staff mode split

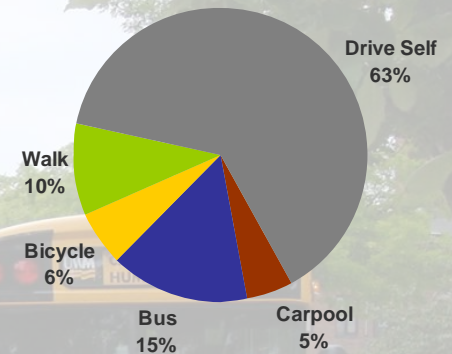

Future student mode split

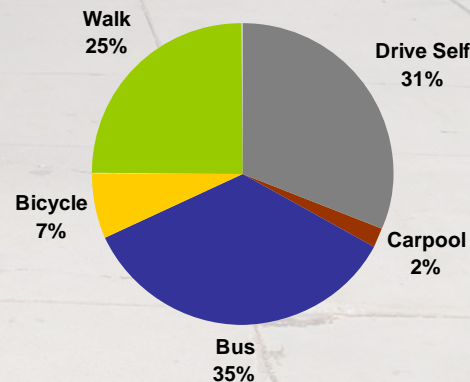

Sustainability

Master Plan addresses:

- Goals & Objectives for sustainability
- Regulatory context for various sustainability indicators in the built environment
- Best Management Practices for future development
- Specific strategies for the Kenwood Campus

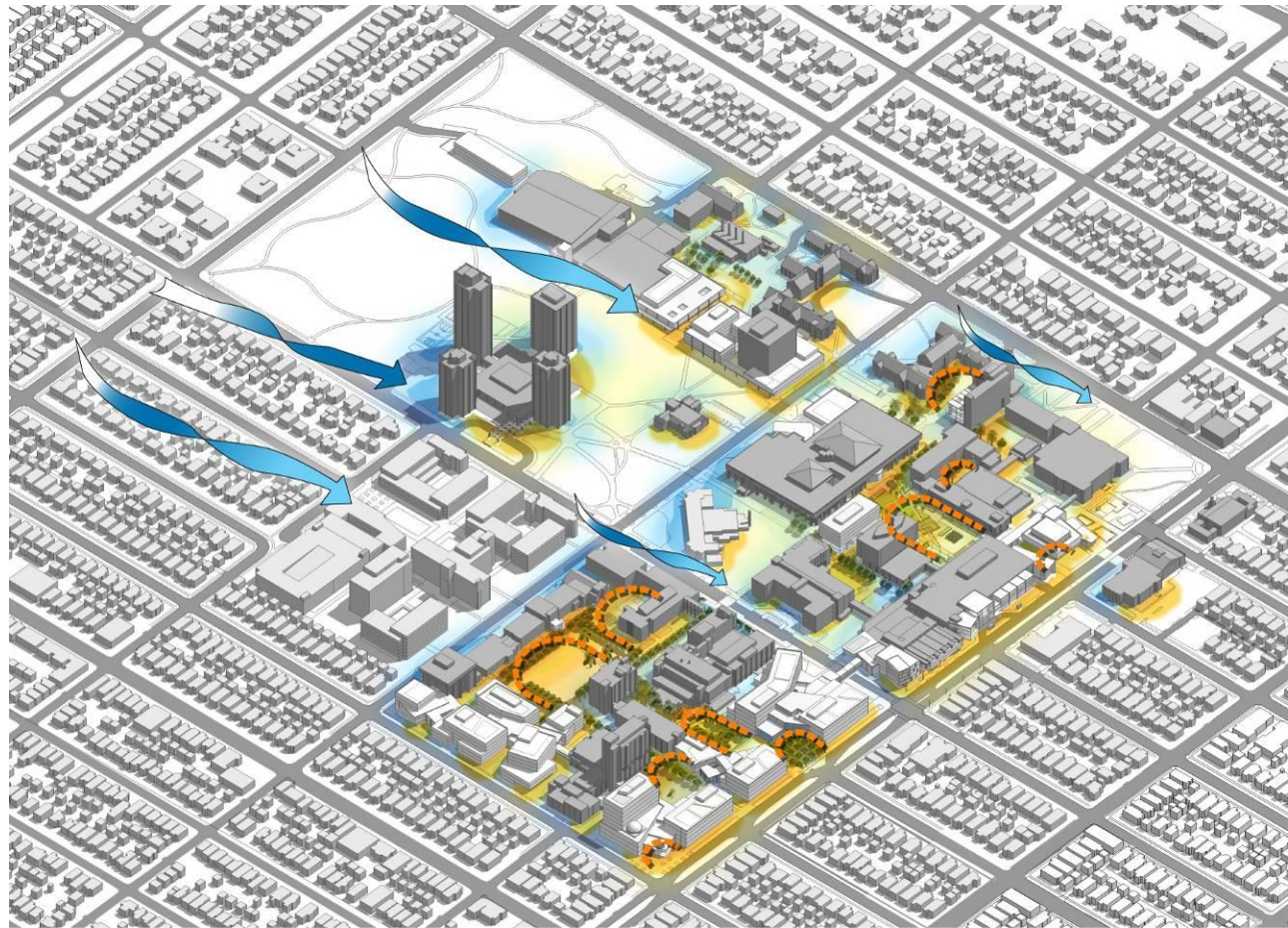

Utilities & Infrastructure

Master Plan addresses:

- Energy/ Performance Goals
- Infrastructure Framework
- Central Plant
- System Reliability
- Growth Demands
- Implementation Strategies

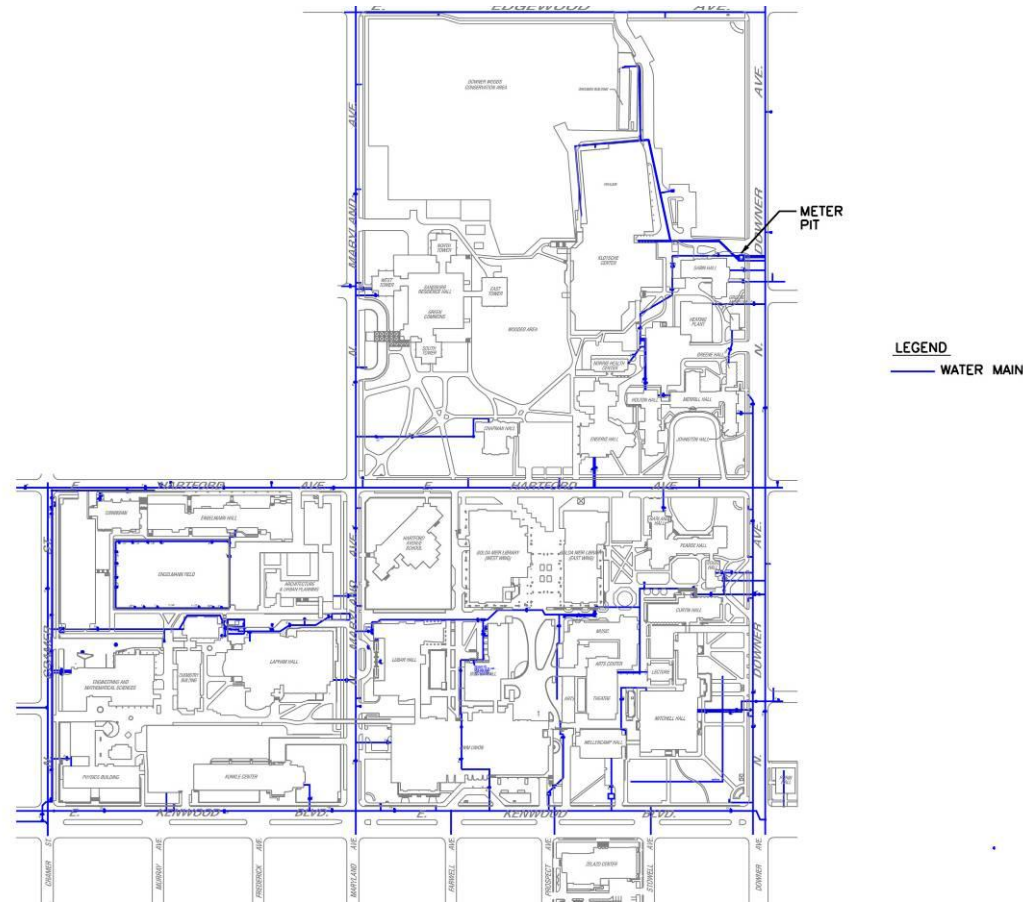



The University of Wisconsin – Milwaukee Master Plan

Board of Regents Presentation - June 10, 2010

